

Recommended Tools

- Safety Glasses
- Tape Measure & Pencil
- Power Drill / (1/2" bits)
- Cable Cutter

● Available from Superior

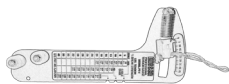

● Tension Gauge (Optional)

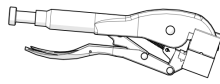

● Cable Locking Pliers

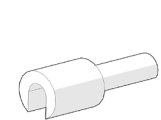

● Cable Release Key



● Cable Cutter

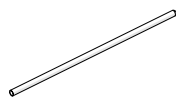

● Threading Needle

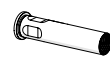

Wood Post Receiver



Lockjaw Housing



Baluster Mount (optional)



Swivel Socket



Threaded Receiver Cap



Threaded Base



Threaded Nut

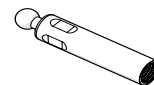

Stair Receiver



Intermediate Baluster

What's Included

- Cable Receiver
- Lockjaw Housing
- Threaded Receiver Cap
- Threaded Base
- Threaded Nut
- #12 Mounting Screw
- Baluster(s) & Baluster Mount

- *These directions are only a guide and may not address every situation.*
- *Always wear proper safety equipment while assembling and installing.*
- *The installer should obtain all required building permits and follow all installation procedures in accordance with applicable building code requirements.*
- *Superior Plastic Products shall not be held liable for improper or unsafe installations.*
- *Applying paint, other than Key-Link's touch up paint, will void your warranty.*
- *To ensure proper coverage by our warranty please visit our website and complete the online warranty registration form or mail a copy to: Superior Plastic Products, 260 Jalyn Drive, New Holland, PA 17557*



WARNING: This product can expose you to chemicals including Quartz (crystalline silica), which is known to the State of California to cause cancer, and Hexavalent Chromium, which is known to the State of California to cause birth defects or other reproductive harm. For more information go to www.P65Warnings.ca.gov.

400 Series Infill Option: (Excluding Cable)

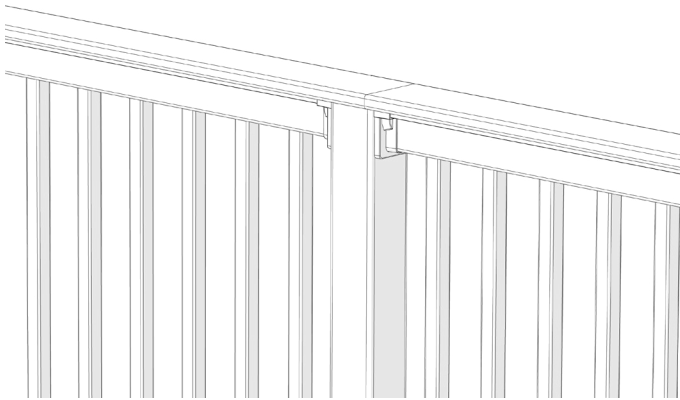

What's Included

- Top and Bottom Rails
- Aluminum Rail Inserts
- Balusters (Aluminum or Vinyl)
- Mounting Brackets w/ screws
- Deck Board Mounting screws

(Posts/ Post Mounts, Caps, & Trim sold separately)

(Optional) Cut Posts to Height

Posts are provided at a standard height, and must be cut to size (Prior to section's installation).
Cut posts to match overall height

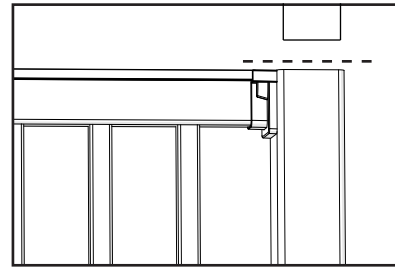

! NOTE: Rail alignment options

Stair posts include a notch which aligns with the top of the top rail. This notch is designed to provide a place to hook your measure tape.

The newel post is shipped with additional length at the top in order to accommodate different installation scenarios. Measure the necessary height per your application and cut your post to size. Using the notch as an indicator of the top rail height.

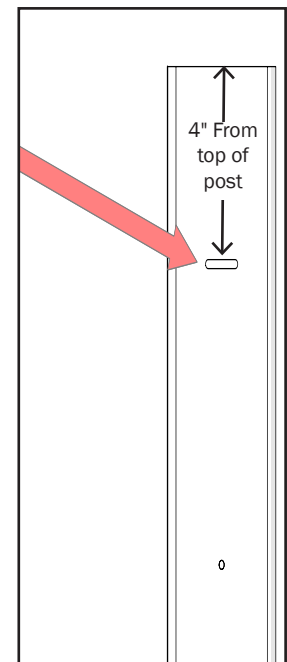

Post Termination

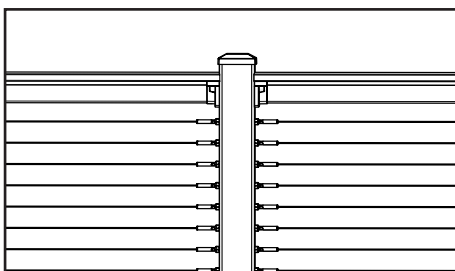

Over Post

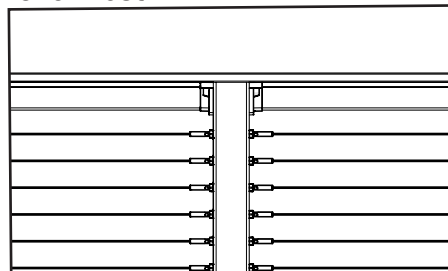

1 Install Newel Post & Post Trim

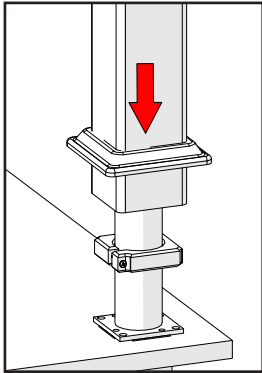

Space Posts according to deck configuration and Top Rail length.

Place Leveling Plate (*highlighted*) between Post Mount and mounting surface. Attach to structural surface using bolts or lags (*not included*). Using a 3/16" Allen wrench, turn set screws to level Post Mount.

First place Trim. Then place Vinyl Post Cover over Post Mount / Wood Beam and Post Spacers.

Check your local building codes to determine structural mounting requirements for Post Mount.

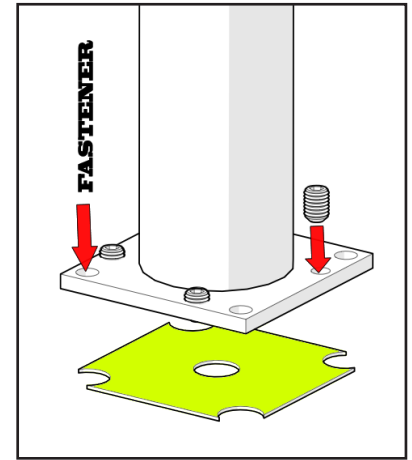

2 Attach Bottom Rail

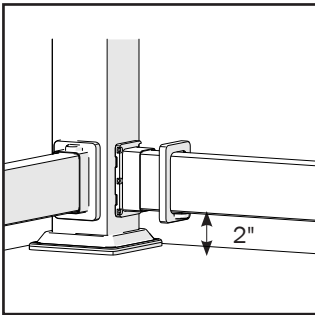

Measure between Posts subtracting 1/4" from total length, and if necessary cut Rails and Rail Insert to proper length by cutting an equal amount from each end. Do not cut through Baluster holes.

Slide the Bracket over the Rails, then put the Rail in place (*2" above mounting surface*) and slide the Bracket against the Post. Fasten Bracket to center of Post using provided screws ensuring at least one screw on either side of the rail penetrates the poly block, and secure Bracket to Railing. Then slide Screw Cover into place.

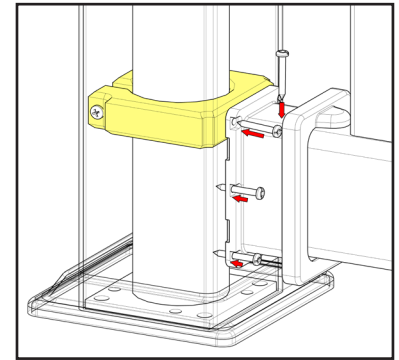

Tip: Cut a block to 2" and set Bottom Rail on it for support during installation

3 Install Balusters

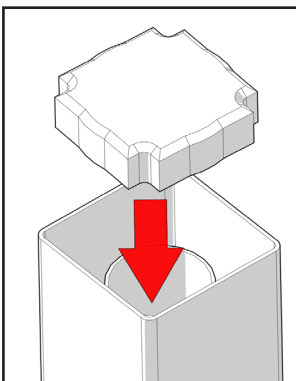

Insert Balusters into the holes in the Bottom Rail. Push firmly to set.

Insert Post Spacers so they remain flush with the top face of Post.

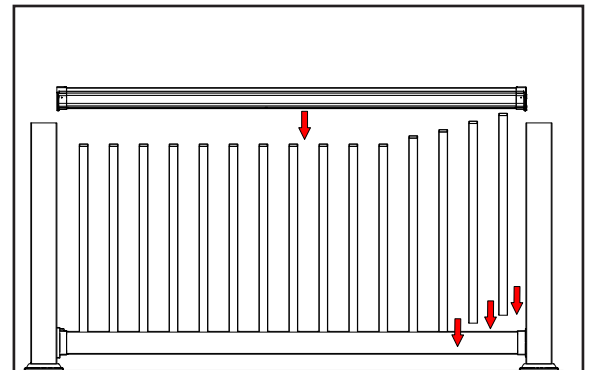
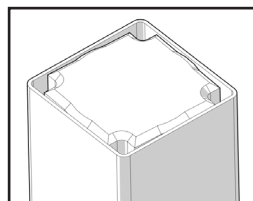

Note: Check local building codes to ensure proper Baluster spacing

400 Series Cable Installation:

1 Install Railing Post

* For stair line posts, Skip to #5

Wooden Posts must be properly secured to framing of deck, and the railing must be placed between top of posts (*reference illustration below*) to ensure proper cable tensioning capability. Ensure post is installed plumb and level.

An appropriate number of balusters is included in your box section of railing.

*Check your local building codes to determine structural mounting requirements for Post.

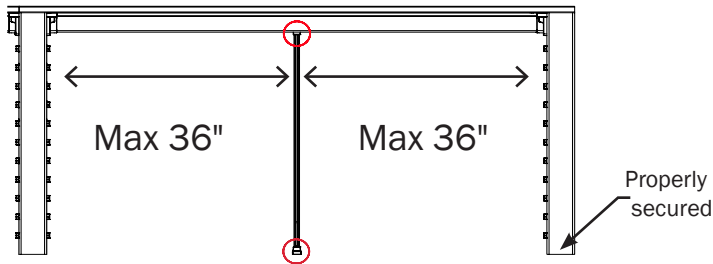

Balusters should be spaced evenly and no more than 36" apart

2 Attach Fitting Receiver to End or Corner Post

For end or corner posts, place newel post and trim ring over post.

Attach threaded base to face of post at each of pre-drilled hole in the vinyl sleeve.

Attach cable receiver to threaded base using threaded nut.

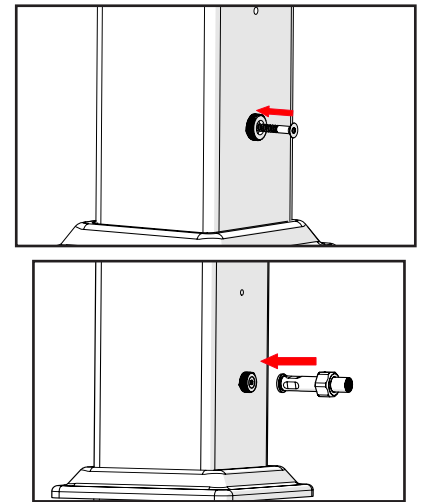

3 Line Post

- Place newel post vinyl sleeve.
- Mark the center of the pilot holes on both sides.
- Remove newel post vinyl sleeve.
- Drill pilot holes from each side meeting in the middle using 1/2" bit.
- Place newel post vinyl sleeve.
- Insert threading needle and cable through drilled holes in post.

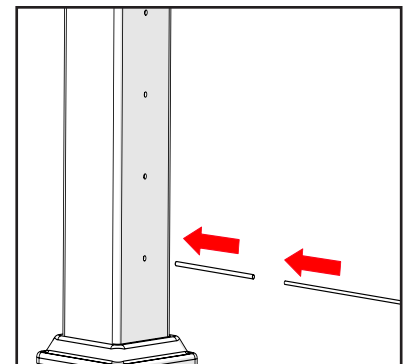
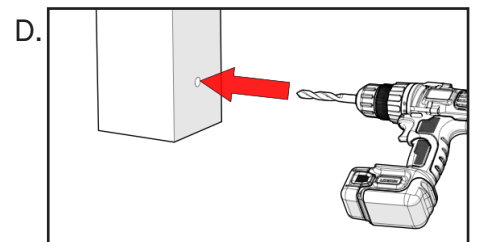
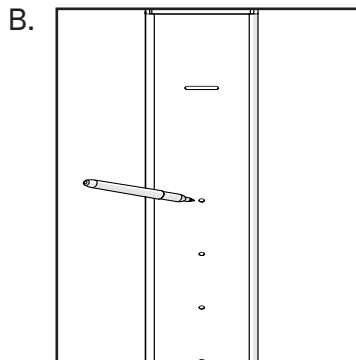
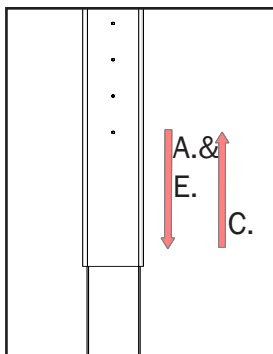

4 Intermediate Baluster

Attach a baluster mount centered (*circled on step 1*) on the bottom surface of the top rail and another to the deck aligned with the baluster mount on the top rail. Use a #12 x 2 1/2" hex head screw to attach the baluster mount to the rail. Use a #12 x 1 1/2" pan head screw to fasten the baluster to the mount on the side.

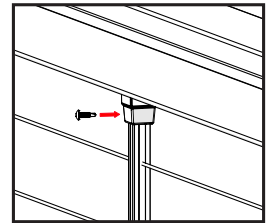
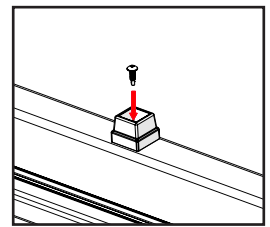

5 Stair Rail

The stair railing post height is determined by the level post at the top of the stair. The newel post is shipped with additional length at the bottom in order to accommodate different installation locations.

Working from the top downward.

To determine placement of the next post; use a straight edge laid flat on the nose of the stairs, Measure off the surface to the first hole on the level post, Translate that measurement to each post/balusters placement on the stair. Then cut the post at the translated marking.

Follow Step 6 for installing receiver and cable.

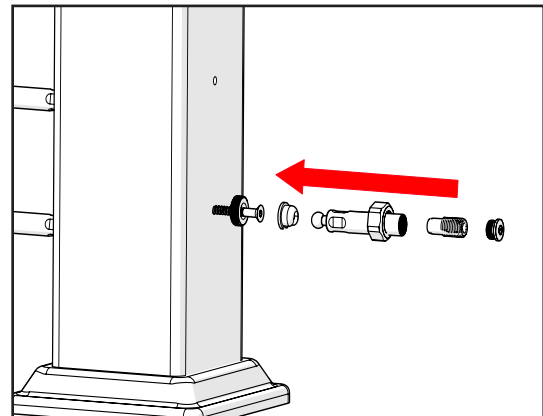
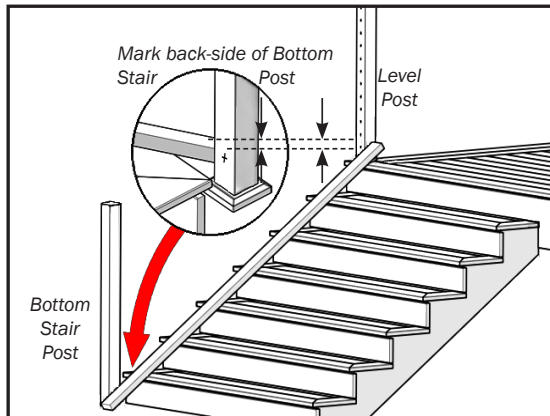

NOTE: How to Loosen Stuck Jaws

! In the event that the jaws of the post receiver become stuck.

Un-tension the cable by holding the cable with cable locking pliers and turning receiver clock wise with a 7/16" wrench. Remove the cap. unthread lockjaw housing completely from receiver.

Cable Release Key

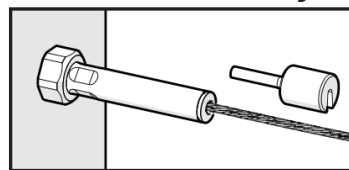

To use the **Cable Release Key**, slide it over the cable into the lockjaw housing, and push to release the cable. For use before the cable is fully tightened.

6 Install Cable

- A. Starting at one end, slide a receiver end cap on to the end of the cable
- B. Secure a lockjaw housing component to the end of the cable ensuring the cable is fully engaged with the internal locking jaws (cable should insert approx 3/4").
- C. Thread this end of the cable into the receiver just enough so end cap can be fully threaded on.
- D. Route your cable respectively through the entire run passing through all balusters and line posts to the opposite end. Pull the cable taught, at 1/2" past the cable receiver end, mark and cut your cable.
- E. Insert cable into receiver.
- F. Repeat steps A-F for each cable run
- G. Using a 3/16" wrench; Hold the cable with cable gripping pliers and rotate counter-clockwise to increase cable tension to your local building code specification.*

*Consult your local building code official for additional cable tensioning requirements

NOTE: Do not exceed 200 lbs. of tension

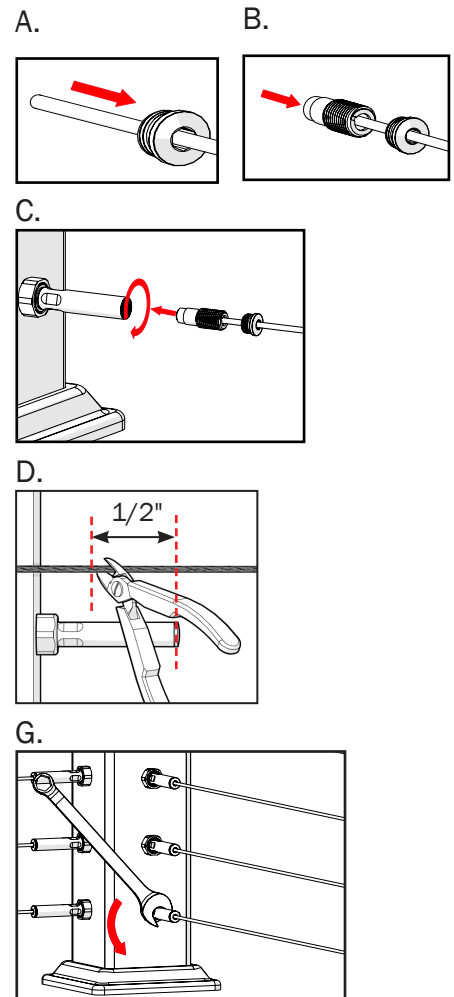

Install Deckboard

Using the provided #8 x 3/4" pan head screws, fasten the deckboard (not supplied) to the top rail from beneath using the predrilled pilot holes of the top rail. It is recommended to pre-drill 1/8" pilot holes in the deckboard.

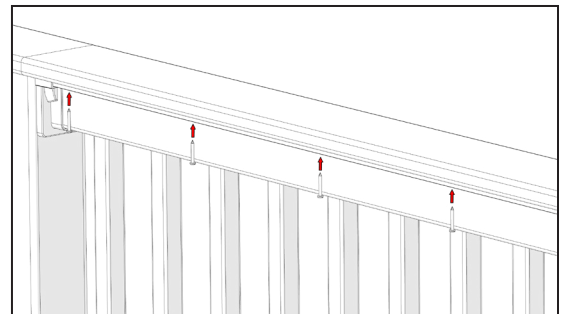

! Drilling Pilot Holes

If the rail has been cut to another length, drill 3/16" pilot holes evenly spaced in the aluminum top rail channel, no more than 12" apart. End pilot holes must be at least 2" from end of rail.

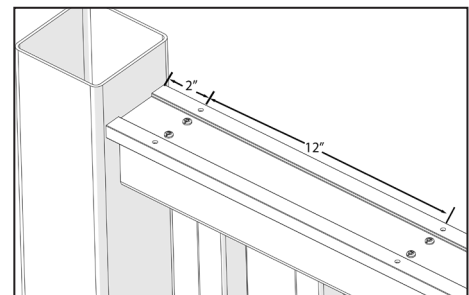

! Corner Install Recommendation

When installing the corner of a railing it is recommended to use wood screws (not provided) to secure the deck board to the internal post poly block. This will ensure the edges of the deckboard do not lift up over time.

